

# Prepare & Apply ProKure V

## ProKure V Liquid

Heavily soiled surfaces must be pre-cleaned prior to treatment.

### Preparing ProKure V Liquid

Ensure all required PPE is worn.

Formula Packet	Item #	# of White Pouches	For Disinfection (100 ppm ClO <sub>2</sub> ) Amount of Water
<b>4.2 Ounces</b> (119 Grams)	<b>FLT-205-V084R</b>	2	Both Pouches in 25 Gallons (95 Liters)
<b>0.84 Ounces</b> (23.8 Grams)	<b>FLT-205-V420R</b>	1	1 Pouch in 5 Gallons (19 Liters)

### Applying ProKure V Liquid

- Spray directly onto surfaces to be treated.
- Product must be used with an exposure time of 10 minutes at 100 ppm to disinfect hard surfaces.
- No wipe, no rinse, no residue.
- Follow ProKure V EPA label when applying to carpets and other color-fast soft goods; test in a hidden area for colorfastness.
- Pour (unused) liquid into a dark closed or sealed container in a cool, dark location. Use stored liquid within 15 days of activation; record activation date onto the container.

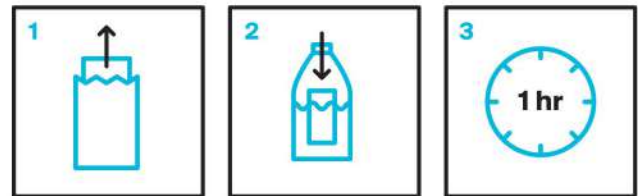

1. Open the silver foil packet and remove the white pouch (DO NOT OPEN THE WHITE POUCH)
2. Place the white pouch in an opaque (not clear) container filled with water
3. Allow pouch to activate in water for one hour to reach maximum strength



#### HELPFUL HINTS

##### ProKure V Liquid

- Kills bacteria, viruses\*, mold
- Easy to use, apply to surface and allow to air dry. Application rates will vary; contact ProKure1 regarding dilutions and contact times or other specific applications like coverage ratios.
- Made in the U.S.A.